

## Issue 7

Attach the die-cast Transmission Case to the Engine Block, and assemble the Alternator and Air Compressor.

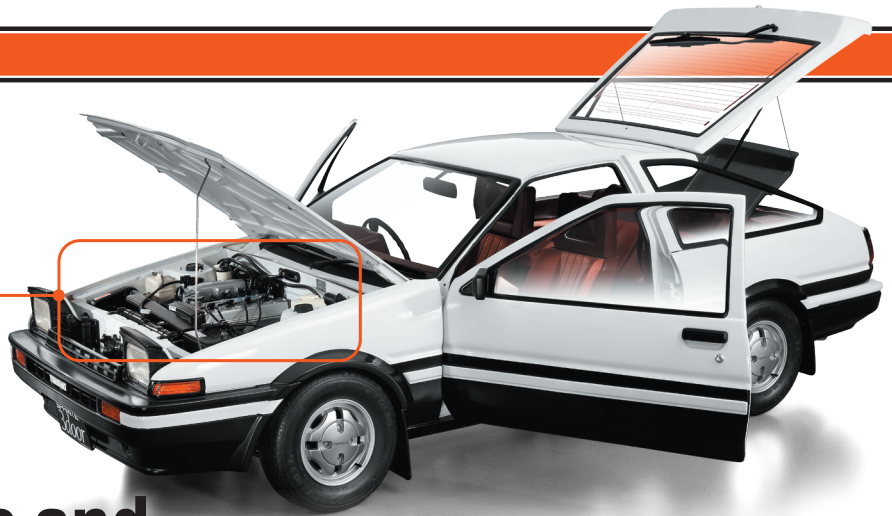

# Attach the Right Transmission Case and Alternator

※ In this guide "Left" or "(L)", and "Right" or "(R)", refer to the direction as viewed from the driver's seat.

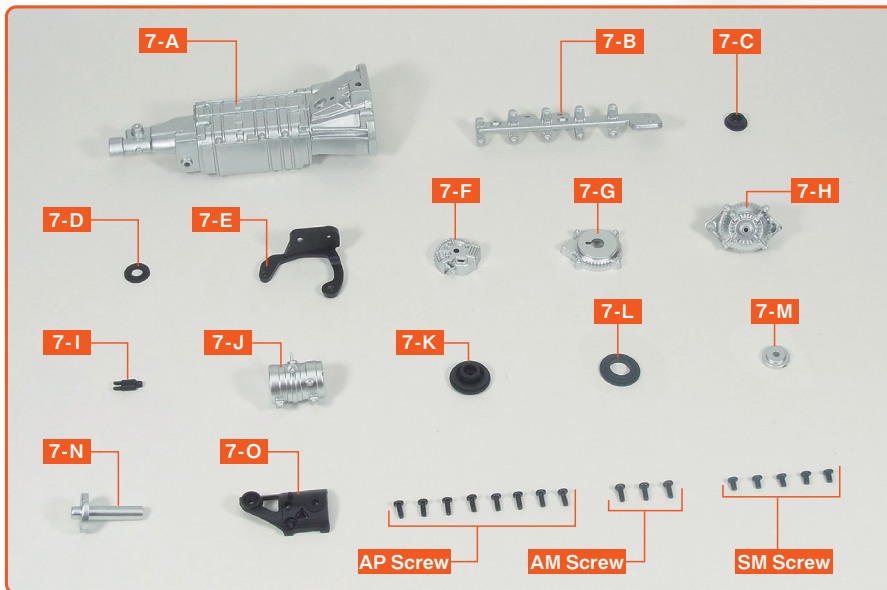

- 7-A** Transmission Case (R)
- 7-B** Mounting Bracket
- 7-C** Alternator Pulley (1)
- 7-D** Alternator Pulley (2)
- 7-E** Alternator Bracket
- 7-F** Alternator (1)
- 7-G** Alternator (2)
- 7-H** Alternator (3)
- 7-I** Connector
- 7-J** A/C Compressor (1)
- 7-K** A/C Compressor Pulley (1)
- 7-L** A/C Compressor Pulley (2)
- 7-M** A/C Compressor (2)
- 7-N** A/C Compressor (3)
- 7-O** A/C Compressor Bracket
- AP Screw** (1.7×4mm) ×8 (2 spare)
- AM Screw** (1.7×4mm) ×3 (1 spare)
- SM Screw** (1.7×3mm) ×5 (1 spare)

View the follow-along video



※Due to the model's design, the shapes of some parts may differ from those of the real vehicle.

## step 1 Attach the Transmission Case

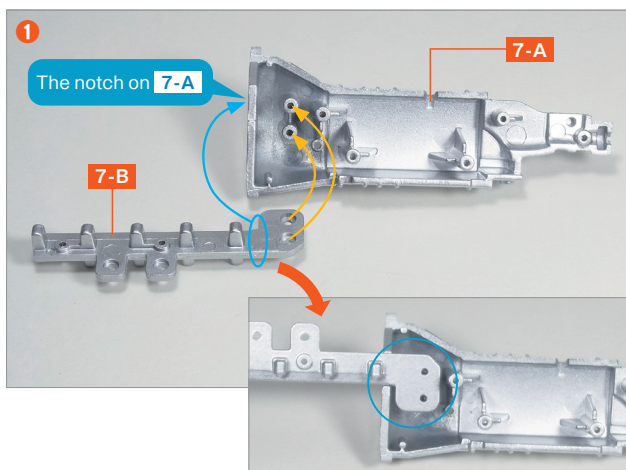

Align the notch and the two screw hole projections on **Transmission Case (R) 7-A** with **Mount Bracket 7-B**, and fit them together.

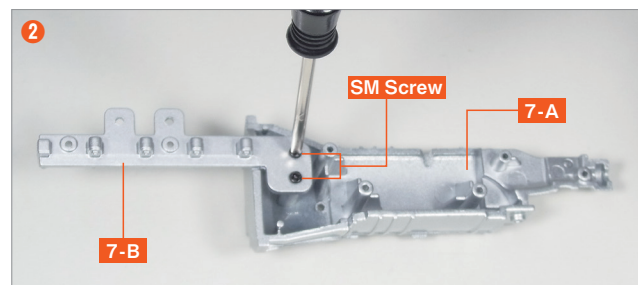

While holding **7-B** in place to prevent it from shifting, secure it with two **SM Screws**.

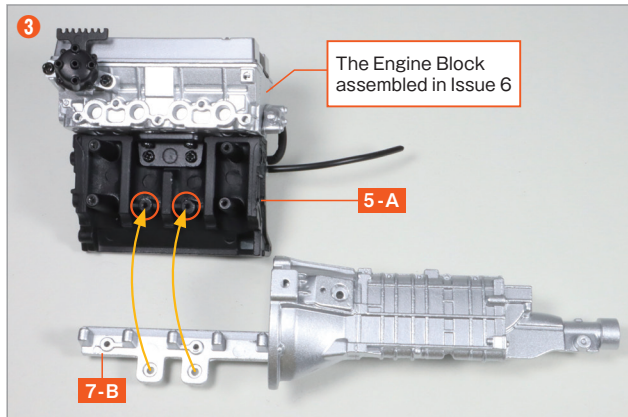

Prepare the **Engine Block** assembled in Issue 6, and align the recesses of the screw holes on **7-B** with the projections of the screw holes on the **Cylinder Block (R) 5-A**.

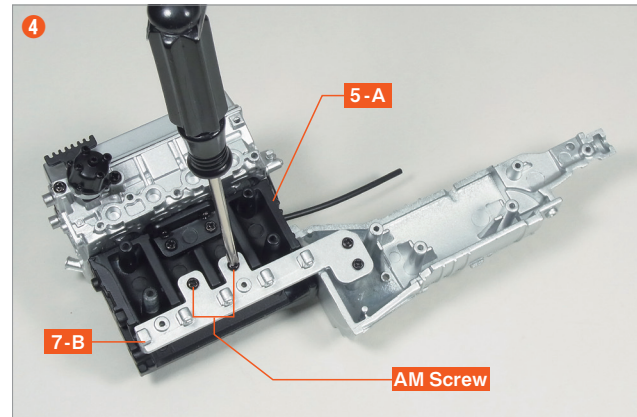

While holding **7-B** and **5-A** in place to prevent misalignment, secure them with two **AM Screws**.

## step 2 Assemble the Alternator and Attach It to the Engine Block

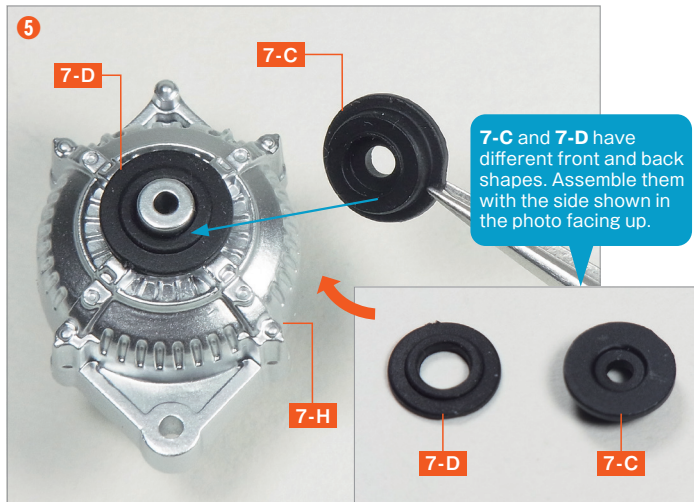

Align the central screw hole projection of the **Alternator (3) 7-H**, and place the **Alternator Pulley (2) 7-D**, followed by the **Alternator Pulley (1) 7-C**, on top of it.

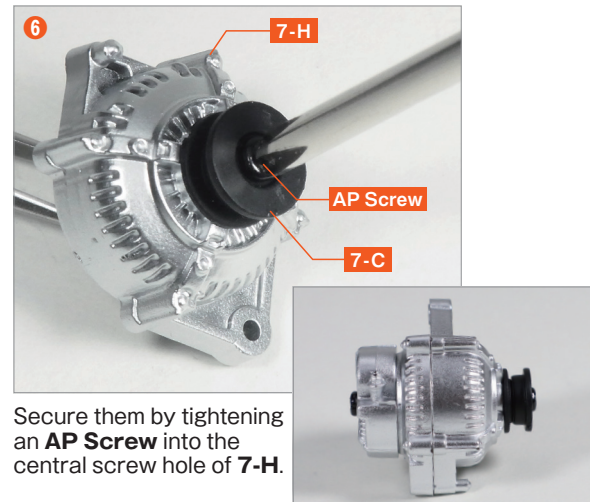

Secure them by tightening an **AP Screw** into the central screw hole of **7-H**.

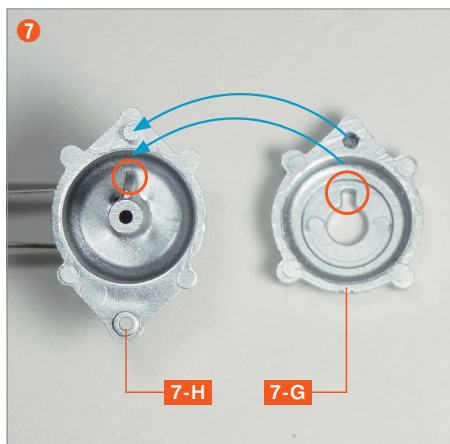

Turn **7-H** over, align the circular recess on **Alternator (2) 7-G** with the screw hole projection on **7-H**, and insert the projection of **7-H** into the hole of **7-G** to secure it.

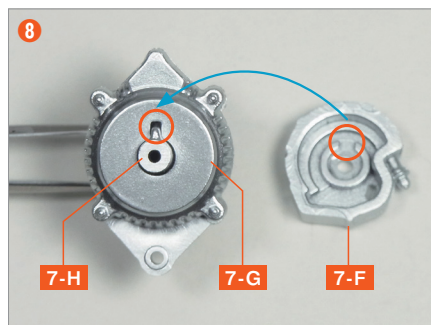

As in step 7, align the notch on the back of **Alternator (1) 7-F** with the screw hole projection on **7-H** and fit it in place.

Tighten an **AP screw** into the central screw hole of **7-F** to secure it. Since **7-F** may shift out of position, adjust it with reference to the photo at the upper right.

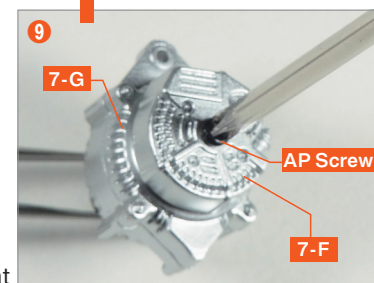
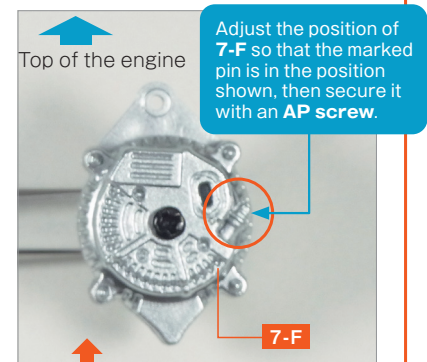



10

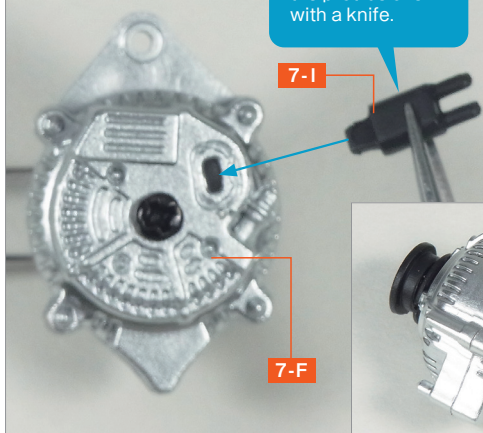

Insert the **Connector 7-I** into the hole on **7-F**. Push it in firmly up to the step.

11

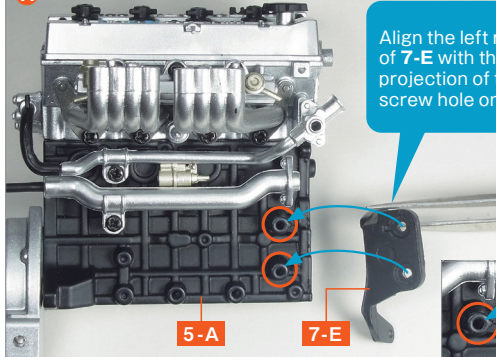

Prepare the engine assembled in **Step 1**, and align the recesses of the screw holes on the back of the **Alternator Bracket 7-E** with the protrusions of the screw holes on **5-A**.

12

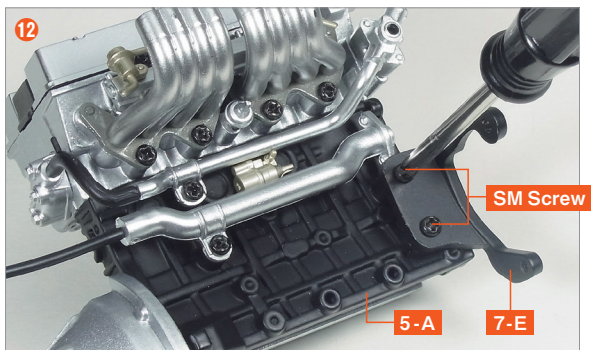

Align the screw holes of **5-A** and **7-E**, and secure them with two **SM screws**.

13

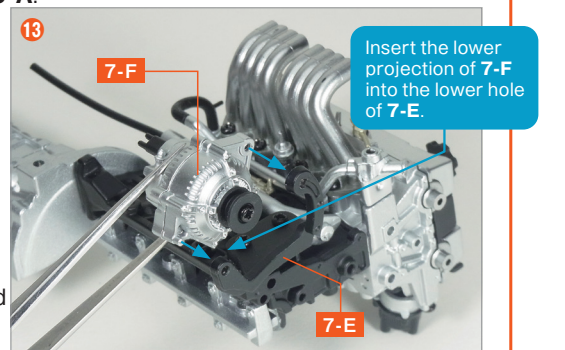

Insert the lower projection of **7-F** into the lower hole of **7-E**.

Place the assembled alternator as shown and fit it with **7-E**.

14

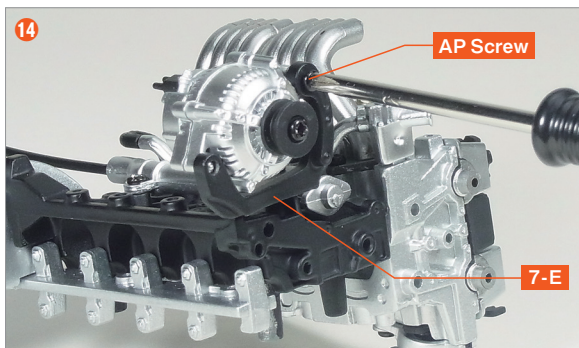

Hold the assembled alternator and **7-E** in place to keep them aligned, match the screw holes, and secure with an **AP screw**.

Step complete

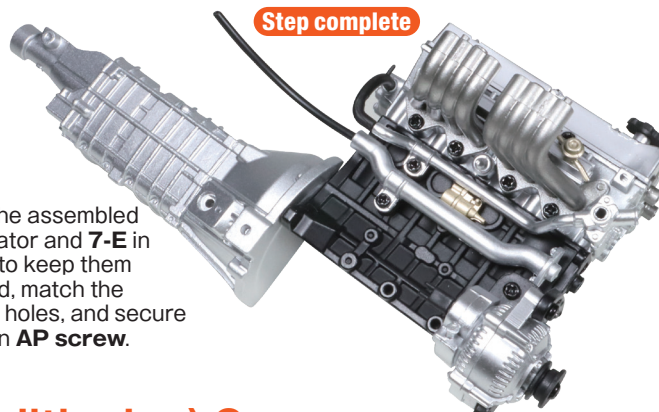

## step 3 Assemble the A/C (Air Conditioning) Compressor

15

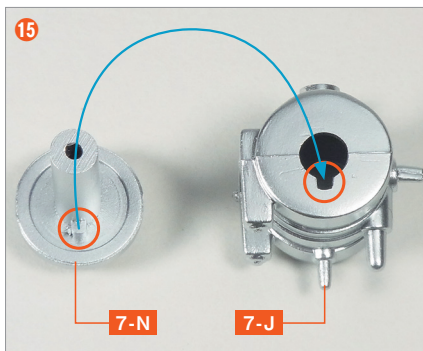

Insert **A/C Compressor (3) 7-N** into **A/C Compressor (1) 7-J**, aligning the projection on **7-N** with the notch on **7-J**, then press them together firmly.

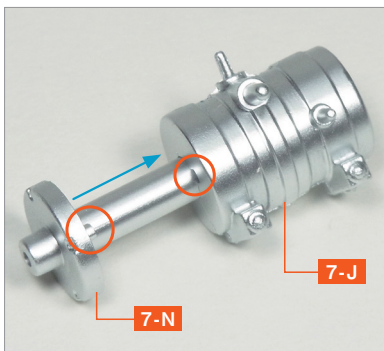

16

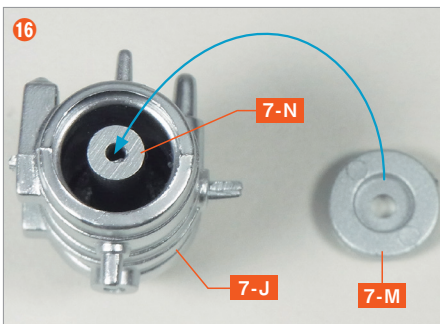

Turn **7-J** over and align the recess on the back of **A/C Compressor (2) 7-M** with the screw hole projection on **7-N**, then fit them together.



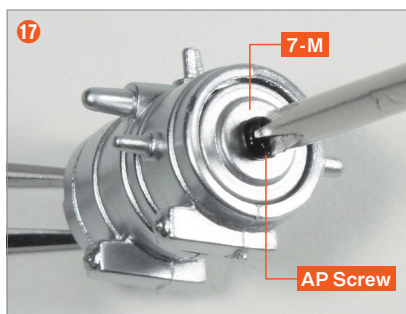

While holding **7-N** in place from the back to prevent it from coming off, tighten an **AP screw** into the centre screw hole of **7-M** to secure it.



Fit **A/C Compressor Pulley (2) 7-L** onto **A/C Compressor Pulley (1) 7-K** in the correct orientation as shown.

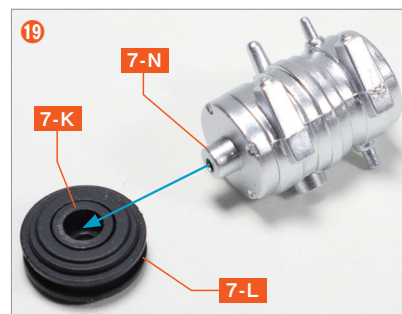

Insert the tip of **7-N** into the centre of the pulley assembly from Step **18**.

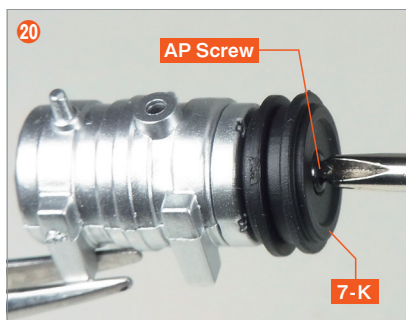

While holding the pulley to prevent it from coming off, tighten an **AP screw** into the central screw hole of **7-K** to secure it.

Insert the projection on **7-J** into the hole on the back of the **A/C Compressor Bracket 7-O**.

Align the screw holes and secure with an **AP screw**.

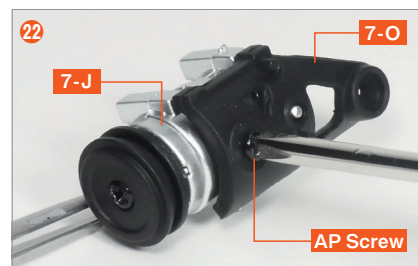
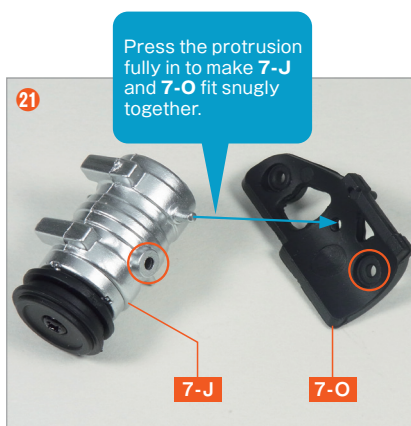

**Step complete**



## Complete

The assembly for Issue 7 is complete. The engine block now has the transmission case and alternator attached, adding more detail. Keep the A/C compressor aside until the next step.

